

Features

- ✧ UL Recognized File # E-326243
- ✧ Dual rectifier construction, positive center-tap
- ✧ Plastic package has Underwriters Laboratory Flammability Classifications 94V-0
- ✧ Metal silicon junction, majority carrier conduction
- ✧ Low power loss, high efficiency
- ✧ High current capability, low VF
- ✧ High surge capability
- ✧ Epitaxial construction
- ✧ For use in low voltage, high frequency inverter, free wheeling, and polarity protection applications
- ✧ Guardring for transient protection
- ✧ High temperature soldering guaranteed:
260°C/10 seconds, 0.17"(4.3mm) lead lengths at 5 lbs., (2.3kg) tension
- ✧ Green compound with suffix "G" on packing code & prefix "G" on datecode.

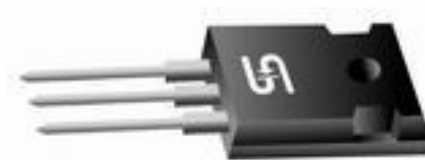

Mechanical Data

- ✧ Cases: JEDEC TO-3P/TO-247AD molded plastic
- ✧ Terminals: Pure tin plated, lead free, solderable per MIL-STD-750, Method 2026
- ✧ Polarity: As marked
- ✧ Mounting position: Any
- ✧ Weight: 5.6 grams

Ordering Information (example)

Part No.	Package	Packing	Packing code	Packing code (Green)
SR1620PT	TO-3P	30 / TUBE	C0	C0G

Maximum Ratings and Electrical Characteristics

Rating at 25 °C ambient temperature unless otherwise specified.

Parameter	Symbol	SR 1620 PT	SR 1630 PT	SR 1640 PT	SR 1650 PT	SR 1660 PT	SR 1690 PT	SR 16100 PT	SR 16150 PT	Units	
Maximum Recurrent Peak Reverse Voltage	V_{RRM}	20	30	40	50	60	90	100	150	V	
Maximum RMS Voltage	V_{RMS}	14	21	28	35	42	63	70	105	V	
Maximum DC Blocking Voltage	V_{DC}	20	30	40	50	60	90	100	150	V	
Maximum Average Forward Rectified Current	$I_{F(AV)}$	16								A	
Peak Forward Surge Current, 8.3 ms Single Half Sine-wave Superimposed on Rated Load (JEDEC method)	I_{FSM}	200								A	
Maximum Instantaneous Forward Voltage (Note 1) @ 8 A	V_F	0.55		0.70		0.90		1.00		V	
Maximum D.C. Reverse Current at Rated DC Blocking Voltage	I_R	0.5				0.1				mA	
		15		10		-				mA	
		-				5				mA	
Typical Junction Capacitance (Note 2)	C_j	700			400					pF	
Typical Thermal Resistance Per Leg	$R_{\theta JC}$	3.0								°C/W	
Operating Junction Temperature Range	T_J	- 55 to + 125					- 55 to + 150				°C
Storage Temperature Range	T_{STG}	- 55 to + 150									°C

Note 1 : 300 us Pulse Width, 1% Duty Cycle

Note 2 : Measured at 1 MHz and Applied Reverse Voltage of 4.0V D.C.

RATINGS AND CHARACTERISTIC CURVES (SR1620PT THRU SR16150PT)

FIG. 1- MAXIMUM FORWARD CURRENT DERATING CURVE

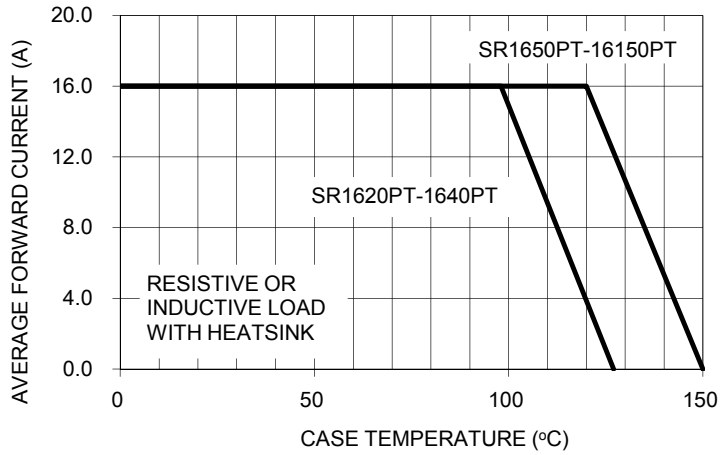

FIG. 2- MAXIMUM NON-REPETITIVE FORWARD SURGE CURRENT PER LEG

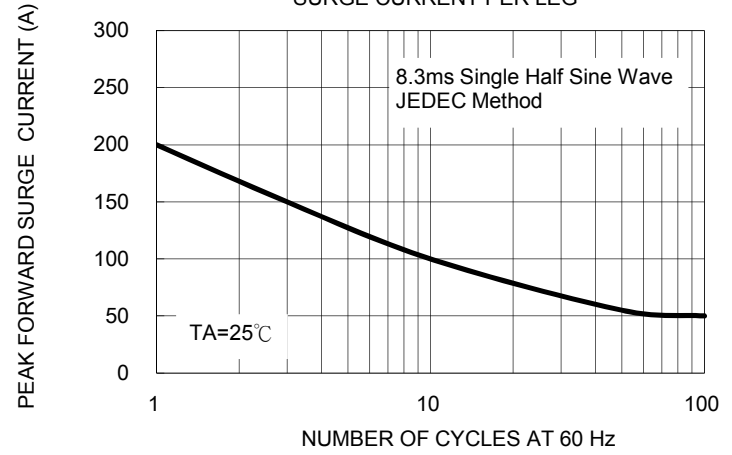

FIG. 3- TYPICAL INSTANTANEOUS FORWARD CHARACTERISTICS PER LEG

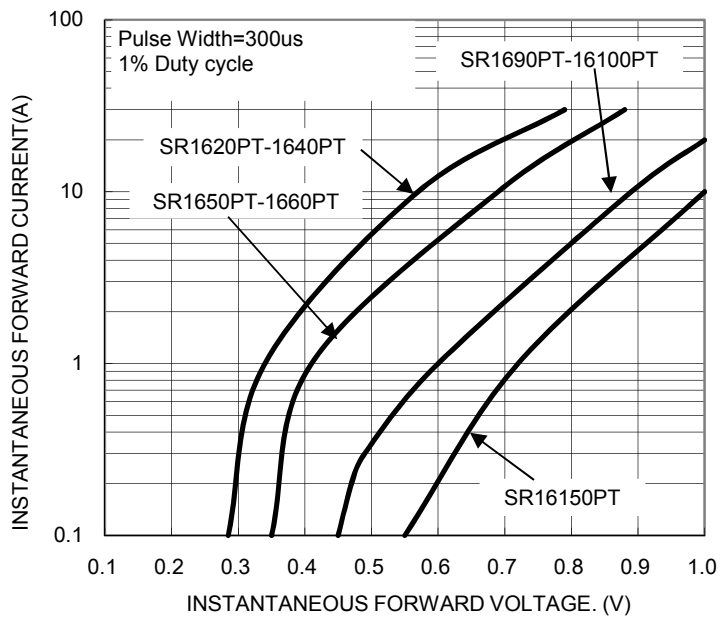

FIG. 4- TYPICAL REVERSE CHARACTERISTICS PER LEG

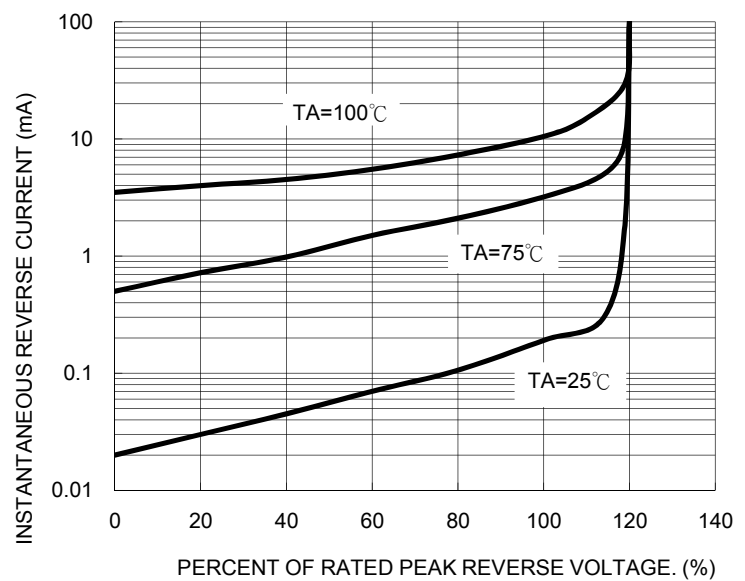

FIG. 5- TYPICAL JUNCTION CAPACITANCE PER LEG

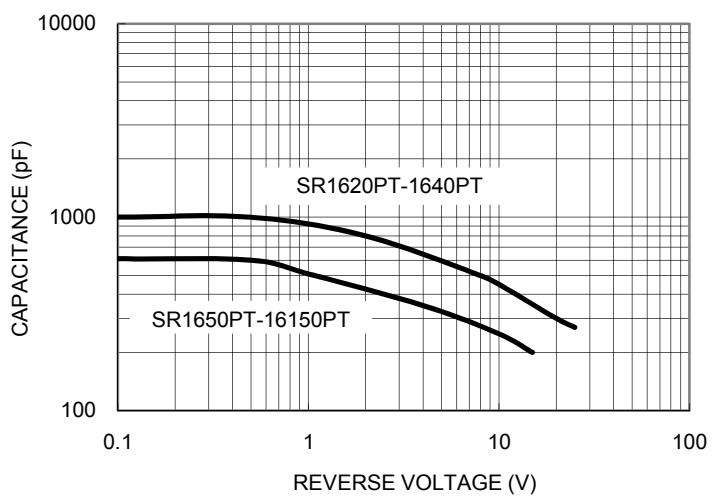
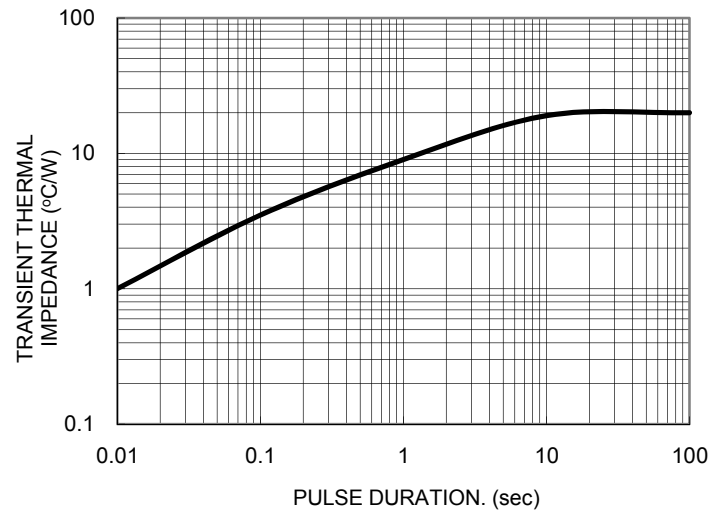

FIG. 6- TYPICAL TRANSIENT THERMAL CHARACTERISTICS



Ordering information

Part No.	Package	Packing	Packing code	Packing code (Green)
SR16xxPT	TO-3P	30 / TUBE	C0	C0G

Note: "xx" is Device Code from "20" thru "150".

Dimensions

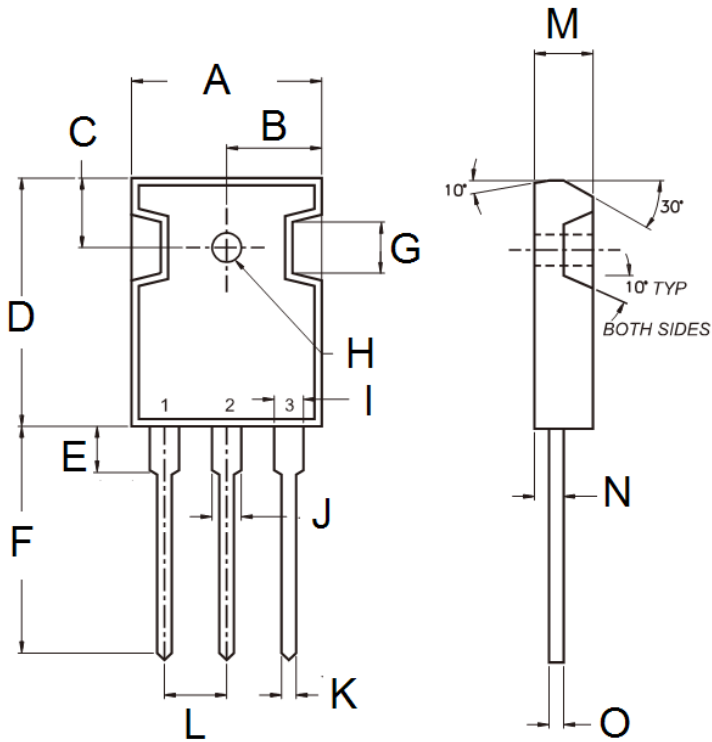

DIM.	Unit(mm)		Unit(inch)	
	Min	Max	Min	Max
A	15.90	16.40	0.626	0.646
B	7.90	8.20	0.311	0.323
C	5.70	6.20	0.224	0.244
D	20.80	21.30	0.819	0.839
E	3.50	4.10	0.138	0.161
F	19.70	20.20	0.776	0.795
G	-	4.30	-	0.169
H	2.90	3.40	0.114	0.134
I	1.93	2.18	0.076	0.086
J	2.97	3.22	0.117	0.127
K	1.12	1.22	0.044	0.048
L	5.20	5.70	0.205	0.224
M	4.90	5.16	0.193	0.203
N	2.70	3.00	0.106	0.118
O	0.51	0.76	0.020	0.030

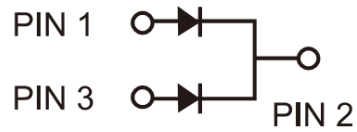

Marking Diagram



- P/N = Specific Device Code
- G = Green Compound
- YWW = Date Code
- F = Factory Code